

**For Industrial Bi-Metal Thermometers
with .250" Diameter Elements**

- .385" bore available for use with instruments with .375" diameter elements
- All Weksler standard thermowells are bored from solid bar stock

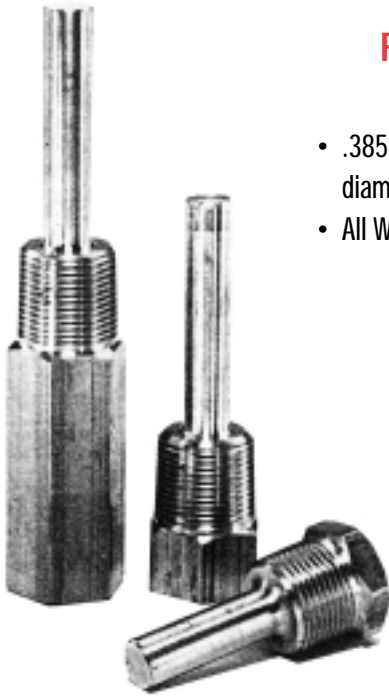

WITHOUT LAGGING EXTENSION

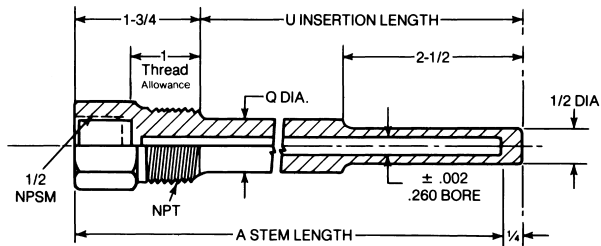

WITH LAGGING EXTENSION

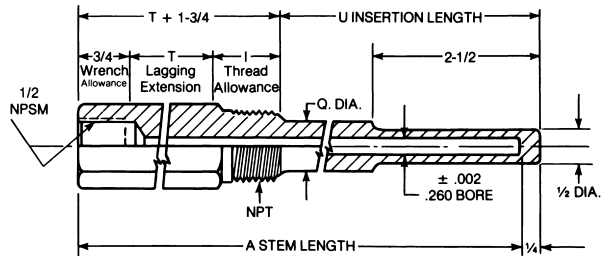

3/4 NPT – CATALOG NUMBERS

A	U	Q	BRASS	STEEL	304 SS	316 SS
4	2½	—	S3B4	S3S4	S3G4	S3J4
6	4½	¾	S3B6	S3S6	S3G6	S3J6
9	7½	¾	S3B9	S3S9	S3G9	S3J9
12	10½	¾	S3B2	S3S2	S3G2	S3J2
15	13½	¾	S3B5	S3S5	S3G5	S3J5
18	16½	¾	S3B8	S3S8	S3G8	S3J8
24	22½	¾	S3BT	S3ST	S3GT	S3JT

3/4 NPT – CATALOG NUMBERS

A	U	T	Q	BRASS	STEEL	304 SS	316 SS
6	2½	2	—	L3B6	L3S6	L3G6	L3J6
9	4½	3	¾	L3B9	L3S9	L3G9	L3J9
12	7½	3	¾	L3B2	L3S2	L3G2	L3J2
15	10½	3	¾	L3B5	L3S5	L3G5	L3J5
18	13½	3	¾	L3B8	L3S8	L3G8	L3J8
24	19½	3	¾	L3BT	L3ST	L3GT	L3JT

1 NPT – CATALOG NUMBERS

A	U	Q	BRASS	STEEL	304 SS	316 SS
4	2½	—	S4B4	S4S4	S4G4	S4J4
6	4½	7/8	S4B6	S4S6	S4G6	S4J6
9	7½	7/8	S4B9	S4S9	S4G9	S4J9
12	10½	7/8	S4B2	S4S2	S4G2	S4J2
15	13½	7/8	S4B5	S4S5	S4G5	S4J5
18	16½	7/8	S4B8	S4S8	S4G8	S4J8
24	22½	7/8	S4BT	S4ST	S4GT	S4JT

1 NPT – CATALOG NUMBERS

A	U	T	Q	BRASS	STEEL	304 SS	316 SS
6	2½	2	—	L4B6	L4S6	L4G6	L4J6
9	4½	3	7/8	L4B9	L4S9	L4G9	L4J9
12	7½	3	7/8	L4B2	L4S2	L4G2	L4J2
15	10½	3	7/8	L4B5	L4S5	L4G5	L4J5
18	13½	3	7/8	L4B8	L4S8	L4G8	L4J8
24	19½	3	7/8	L4BT	L4ST	L4GT	L4JT

Brass wells are not recommended for installations involving high pressures and/or temperatures over 400°F.

Brass cap and chain available to keep bore clean when not in use.

.260" bore standard. If .385" bore is required: (1) add the letter K at the end of the catalog no.; (2) "Q" diameter is changed to 49/64" along entire length of insertion ("U" dimension).

For pressure – temperature rating use Table 1 on page 60.

NOTE: 2½" STEM THERMOMETERS USE SPECIAL LIMITED SPACE WELLS.

Limited Space Wells

Fits Weksler 3" and 5" bi-metal thermometers with 2 1/2" stem length. It is recommended that these be used only when space is such a critical factor that wells for 4" stem length bi-metals cannot be utilized.

CATALOG NUMBERS				
	BRASS	STEEL	304 SS	316 SS
3/4 NPT	S3B1	S3S1	S3G1	S3J1
1 NPT	S4B1	S4S1	S4G1	S4J1

Brass wells are not recommended for installations involving high pressures and/or temperatures over 400°F.

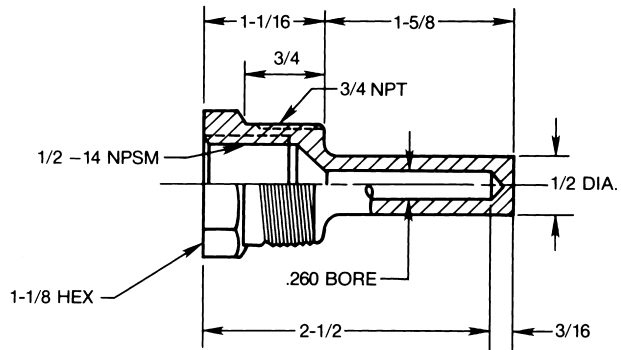

IMPORTANT NOTE:

The above limited space thermowells should not be used with Weksler 3" or 5" bi-metals with the following ranges: 25/125°F, -40/120°F, 0/150°F, 50/500°F, 150/750°F, 0/50°C, -50/50°C, 0/300°C and 100/400°C. These ranges must use thermometers with 4" minimum stem length.

Heavy Duty Threaded Wells

WITHOUT LAGGING EXTENSION

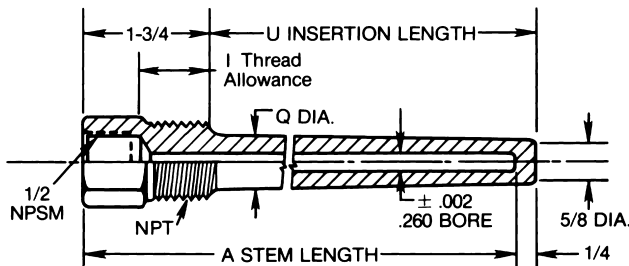

WITH LAGGING EXTENSION

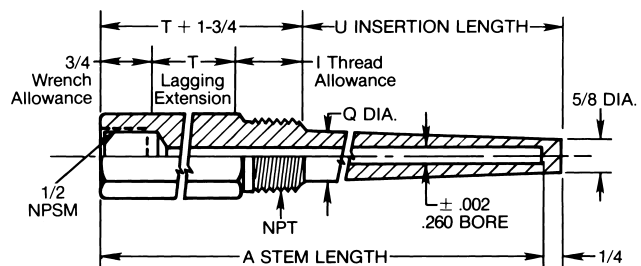

3/4 NPT - CATALOG NUMBERS

A	U	Q	STEEL	304 SS	316 SS
4	2 1/2	7/8	S3S4H	S3G4H	S3J4H
6	4 1/2	7/8	S3S6H	S3G6H	S3J6H
9	7 1/2	7/8	S3S9H	S3G9H	S3J9H
12	10 1/2	7/8	S3S2H	S3G2H	S3J2H
15	13 1/2	7/8	S3S5H	S3G5H	S3J5H
18	16 1/2	7/8	S3S8H	S3G8H	S3J8H
24	22 1/2	7/8	S3STH	S3GTH	S3JTH

3/4 NPT - CATALOG NUMBERS

A	U	T	Q	STEEL	304 SS	316 SS
6	2 1/2	2	7/8	L3S6H	L3G6H	L3J6H
9	4 1/2	3	7/8	L3S9H	L3G9H	L3J9H
12	7 1/2	3	7/8	L3S2H	L3G2H	L3J2H
15	10 1/2	3	7/8	L3S5H	L3G5H	L3J5H
18	13 1/2	3	7/8	L3S8H	L3G8H	L3J8H
24	19 1/2	3	7/8	L3STH	L3GTH	L3JTH

1 NPT - CATALOG NUMBERS

A	U	Q	STEEL	304 SS	316 SS
4	2 1/2	1 1/16	S4S4H	S4G4H	S4J4H
6	4 1/2	1 1/16	S4S6H	S4G6H	S4J6H
9	7 1/2	1 1/16	S4S9H	S4G9H	S4J9H
12	10 1/2	1 1/16	S4S2H	S4G2H	S4J2H
15	13 1/2	1 1/16	S4S5H	S4G5H	S4J5H
18	16 1/2	1 1/16	S4S8H	S4G8H	S4J8H
24	22 1/2	1 1/16	S4STH	S4GTH	S4JTH

1 NPT - CATALOG NUMBERS

A	U	T	Q	STEEL	304 SS	316 SS
6	2 1/2	2	1 1/16	L4S6H	L4G6H	L4J6H
9	4 1/2	3	1 1/16	L4S9H	L4G9H	L4J9H
12	7 1/2	3	1 1/16	L4S2H	L4G2H	L4J2H
15	10 1/2	3	1 1/16	L4S5H	L4G5H	L4J5H
18	13 1/2	3	1 1/16	L4S8H	L4G8H	L4J8H
24	19 1/2	3	1 1/16	L4STH	L4GTH	L4JTH

Brass cap and chain available to keep bore clean when not in use.

.260" bore standard. If .385" bore is required: (1) change the last digit of the catalog no. from H to L; (2) "O" diameter will be 1 1/8" on all and diameter at the end of taper (bottom of well) will be 49/64".

For pressure and temperature rating use Table 2 on page 60.

NOTE: ALL WEKSLER STANDARD THERMOWELLS ARE BORED FROM SOLID BAR STOCK.