

THERMOWELL MEETS USDA, FDA AND 3A SANITARY STANDARD 09-08

Sanitary instruments are designed for applications in the food, dairy, pharmaceutical, cosmetic, and beverage industries. The standard Tri-clamp fittings have no exposed threads and prevent the process from entering the instruments.

CATALOG NO.	CLAMP SIZE	STEM LENGTH	'U' DIMENSION
D8J4	1½"	4"	2½"
D8J6	1½"	6"	4½"
D9J4	2"	4"	2½"
D9J6	2"	6"	4½"

HOW TO ORDER

ORDER THERMOWELL BY 4 DIGIT CATALOG NUMBER FROM TABLE ABOVE.

REFER TO PAGE 15 FOR SANITARY GAUGES

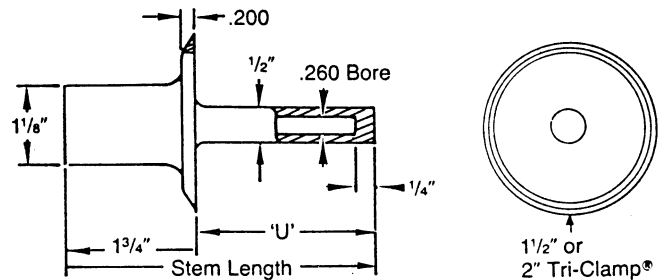

Bi-Metal to Industrial Well Conversion Kit

With this kit, an existing Industrial Thermometer Well can be used to accept a Bi-Metal Dial thermometer. Kit consisting of a liner, an adaptor nut, a spring and heat conducting medium.

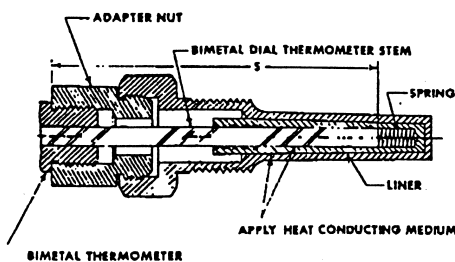

SPECIFY CATALOG NUMBER "BIK-A"

1/2 NPT Flange

Satin finish chrome plated brass. For use in air ducts, dryers, ovens, etc.

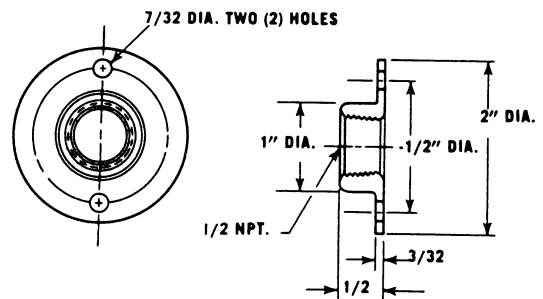

SPECIFY CATALOG NUMBER "2F2"